

Connection of your receiver:

1. Unplug your motor
2. Check that your receiver is supplied with a 12V or 24V power supply. If the voltage delivered by the circuit board of your motor is greater (for example, 220V), you will have to install a transformer.
3. If the supply power is 12V, put the switch 12V-24V on 12V, if it is 24V, put the switch on 24V.
4. Make the following connections with the electric wires as indicated on the diagram above:
  - Connect channel 1 between terminals 3 and 4 on the receiver (you have to insert the wire in the hole under the screws and then screw them to lock the wire)
  - Connect channel 2 between terminals 5 and 6 on the receiver.
  - Connect the terminal + of the motor (or terminal with a tension indication) to terminal 1 on the receiver
  - Connect the terminal – or GMD of the motor to terminal 2 on the receiver

## Programming of the first remote control:

1. Open the casing of your receiver. It is located next to your motor.
2. On the receiver circuit board, press the button CH1.
3. While keeping the button CH1 pressed down, press the first button on your new remote control. Let the buttons go.
4. On the receiver circuit board, press the button CH2.
5. While keeping the button CH2 pressed down, press the second button on your new remote control. Let the buttons go.
6. Your new remote control is programmed.

## Programming of the following remote controls:

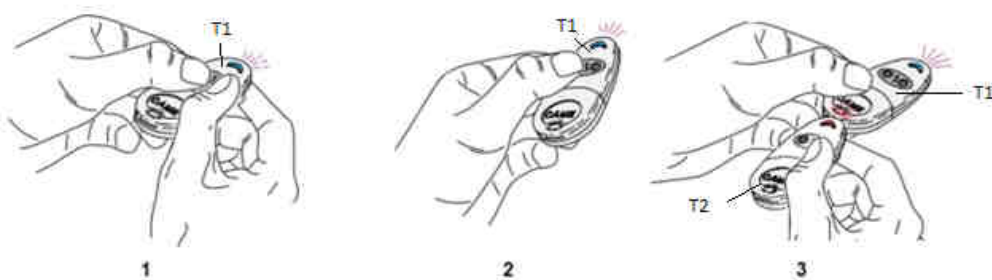

**During the coding process, if you press one of the buttons of the new remote control first, you run the risk of erasing the codes of all of the remote controls that have already been programmed**

1. Press both top buttons on your new remote control at the same time (1). Keep them pressed down. The LED light on your new remote control blinks slowly and then faster. Let the buttons go.
2. Press the button of your new remote control. Let it go. The LED light on your new remote control remains lit constantly (2).
3. Place an already-programmed remote control (T2) next to the new remote control (T1) so they touch as shown in the diagram above (3). The LED light on your new remote control blinks three times.
4. Your new remote control is programmed.